



# Visoon HD900

Ver: 1.0



**Manual for Multi-screen Tablet Visoon HD900**

# Visoon HD900

Ver: 1.0

## ***Features:***

Analog and digital video input. You can connect your portable DVD player, professional camera, Raspberry PI, Zotac Zbox Pico, Xbox, PS or FPV equipment via HDMI and use it as a screen for preview. Also possible to connect analogue video sources like digital camera or video transmitters etc. Unique feature worldwide the analogue video input!  
Compatible with DJI Phantom 3/4 / Inspire / Matrice etc.

## ***Hardware:***

9 " touchscreen, state of the art Exynos 5260 processor, 2GB RAM and 64GB EMMC storage.  
Equipped with a 2K HD display resolution of 2560 \* 1600 pixels, a brightness of 500cd/m2 and a non-glare display, it perfectly match outdoor activities. Front and back camera for photo and video recording. Supports WiFi 802.11 b/g/n, Bluetooth 4.0 and GPS navigation. Integrated speakers.  
Android 4.4.2.

# Content

Instructions.....	02
Main Functions.....	04
Power on/off Operation.....	05
Battery Management and Charging.....	06
Utilization of Function Icon.....	06
Wi-Fi.....	07
Bluetooth.....	07
HDMI Input.....	09
AV Input.....	09
HDMI Output.....	09
USB Interface.....	10
Use TF Memory Card.....	14
APK Install and Uninstall.....	14
Music.....	15
Video.....	16
Camera.....	16
Gallery.....	19
Resource Manager.....	20
IE Internet Explorer.....	21
Email.....	21
Inbox.....	22
Map.....	23
Voice Search.....	24
Calendar.....	24
Calculator.....	25
Alarm Clock/Countdown Counter/Stopwatch.....	25
Setting.....	26
Software Upgrade.....	32
Main Specification Table.....	33
Troubleshooting.....	34

# Instructions

## ◆ Points for Attention

Thank you for using the product of our company. We will provide reliable products manufactured and tested under the strict environment for you. In order to play all performances of the multi-screen tablet and avoid improper use and operation, please carefully read this operation manual before using this product, thank you!

- Don't place the multi-screen tablet under hot, cold, dust and damp environment.
- Don't let the multi-screen tablet fall down or collide the TFT screen with hard objects when using this product as it will damage the screen and TFT displays abnormally. Users will be responsible for product damage due to personal causes or other force majeure.
- Don't arbitrarily unload application program , so as not to create the tablet or part of the function can not be used.
- Try to avoid the operation of the tablet in a dry environment, in order to prevent static electricity.
- Keep the tablet far away from the electromagnetic field of other electrical equipment such as audio; loudspeaker of the audio may generate very strong magnetic field. Open magnetic field may make data lose and damage LCD screen.
- Don't charge the tablet with other excluded equipment, otherwise, there will lead to battery fires and damage risk.
- Keep away from combustion source when using the tablet, otherwise, it may cause battery explosion or ignition risk.
- Don't place heavy objects on the tablet, otherwise, it will damage the tablet.
- When the computer is used as a mobile HDD, users shall export documents by correct document management operation method. The company is not responsible for any error operation caused fire lost.
- The charging voltage of the product is 5V, please use standard special charging equipment to charge the product.
- When using earphone, please guarantee the volume of the earphone is within the acceptable scope to avoid damaging your hearing.

**Note: the company reserves the right of improving the product. Performances and functions of product with different hardware and software versions may generate certain differences. Therefore, additional notice will not be issued for incurred change.**

## ◆ Reduce battery consumption

The tablet provides some options for helping you to save battery volume. The utilization time of the tablet can be extended after each charge by customizing the following options and canceling the running function in the background.

Start power saving mode.

- When not in use, you can switch to sleep mode by pressing the power button.
- Close unnecessary application program via task manager.
- Cancel Bluetooth function.
- Cancel WLAN function.
- Cancel automatic synchronizing function of application program.
- Reduce the time of background light.
- Turn down the brightness of the display screen.
- Turn down the volume and so on.

# Instructions

## ◆ Know your tablet and accessories

● Appearance and accessories



Definition description of HD900 component interface function	
1. Charging Indicator	2. Built-in MIC
3. Micro USB Interface	4. Earphone Interface
5. AV IN Interface	6. HDMI IN Interface
7. HDMI OUT Interface	8. TF Card Slot
9. Volume -	10. Volume +
11. Power	12. Optical sensor
13. Front Camera	14. Loudspeaker
15. Loudspeaker	16. Rear Camera
17. Flashlight	

# Instructions

● Accessories



## Main functions

- Screen specification: 9 inch 2K super HD LCD screen (2560\*1600) , 16:9; brightness: 500cd/m2; contrast ratio: 1200:1; 16000000 colors, adopts 10 point capacitive touch screen with anti glare enhancement processing.
- Android 4.4.2 intelligent operating system, built-in Wi-Fi module; it can work in places with hot spot or WIFI network. It can provide many application experiences, such as web browser, news information, instant message, email, micro-blog, online games, online video, stock quotes, weather forecast, map and interesting software and so on.
- Support Bluetooth 4.0.
- Support GPS navigation.
- HDMI OUT interface (high-definition output interface HDMI1.4), externally connected to display equipment.
- HDMI IN interface(high-definition input interface HDMI1.4), (support1080i/P@30/24Hz, 720p@60Hz,480P@60Hz), externally connected to HDMI signal input.
- AV interface (analog signal input interface) ,support PAL/NTSC automatic identification, resolution ratio 640\*480,input signal 720\*576.
- Built-in G-Sensor gravity sensor, automatically rotate display contents according to holding direction so that you can select the most suitable angle under various application environment and you can experience wonderful G-sensor gravity sensing game.
- LCD screen can automatically adjust brightness according to environment light.
- Support multi-media video format: comprehensively support high-definition 1080P (1920×1080) video documents with format of AVI、MOV、MEPG 1/2/4、H.264、FLV and WMV.
- Support multi-media audio format: MP3, WMA, WAV, AAC, OGG and other formats of music files, support a variety of EQ mode, support multi-task operation.
- Support high-definition picture files with formats of JPEG, BMP and GIF, support functions of thumbnail browser, lantern slide play, picture rotating and picture zoom.
- Memory device: in addition to internal memory, it also supports TF expansion. The tablet can use memory card with the maximum capacity of 64GB (relying on manufacturing of memory card and type). Some memory cards are incompatible with our tablet, please use genuine memory card.
- Equip with high-definition front camera (5.0 megapixel ) and high-definition rear camera (8.0 megapixel).
- Support interfaces: earphone, micro USB, TF card, HDMI input, AV input, HDMI output.

## Power on/off operation

● **Power on /unlock:** under state of power off, press “power on-off key” for 3 seconds, the system displays starting LOGO and enters into the desktop of the system in about 30 seconds. The screen is under locking state, press the icon of “🔒” for unlocking by right sliding, the tablet will be automatically unlocked and enter to the home screen. As shown in the drawings:

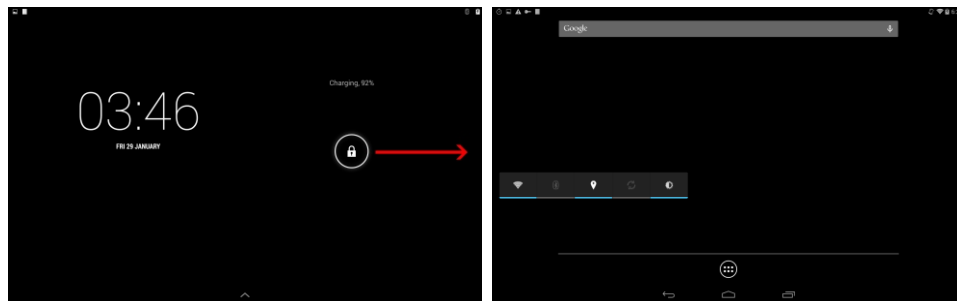

● **Power saving mode and screen locking:** press “power on/off key” for a short time after starting, the system will go into the SLEEP power saving mode, the screen will be black, meanwhile, it will go into screen locking state. Press “power on/off key” again, system to restore the state of the light screen within 1S.

● **Power off:** under starting state, press the on/off key for 3 seconds, the power off confirmation interface will be displayed on the screen, which is shown in the figure:

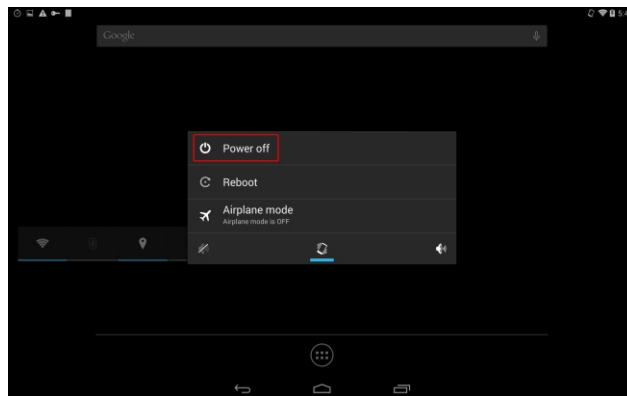

Select “POWER OFF” and click “OK” for confirmation, then the system will automatically power off.

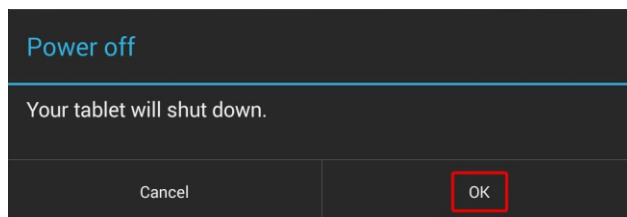

**[Attention]:** when the electric volume is low, the tablet will continuously alarm. If it is not charged, the tablet will automatically power off; if it can not start, Please check whether the machine battery has electricity, to ensure that there is a certain amount of electricity, and then try to boot.

## Battery management and charging

When the tablet is used for the first time, you should power the tablet off to charge 5~6 hours to ensure the full charge of the battery and then use.

Correctly Insert the miniature end of the power adapter into the USB MICRO socket of the tablet while the other end will be inserted into power socket. The charging indicator light of the tablet is red, the desktop battery icon “🔋” turns green, it means charging is on, please wait until the battery is charged sufficiently, please don't remove the charger in the process. The charging indicator light will turn green after charging is completed, if the green strip on the desktop battery icon “🔋” is stationary, it indicates charging is completed.

When you are in a state of full run out of battery power, please wait for a minute, and then restart.

### [Attention]:

In order to ensure the best use status of lithium battery, please note the following:

- Don't charge under high temperature environment (Like a balcony or direct sunlight).
- Lithium battery needn't be discharged, also do not need to be exhausted before charging, you can charge when the battery is still with some electric volume.
- If you do not use the tablet for a long time, please fully charge it once at least two weeks, so as to avoid excessive battery discharging and affect the charging performance.

## Utilization of Function icon

● Definition of desktop icons

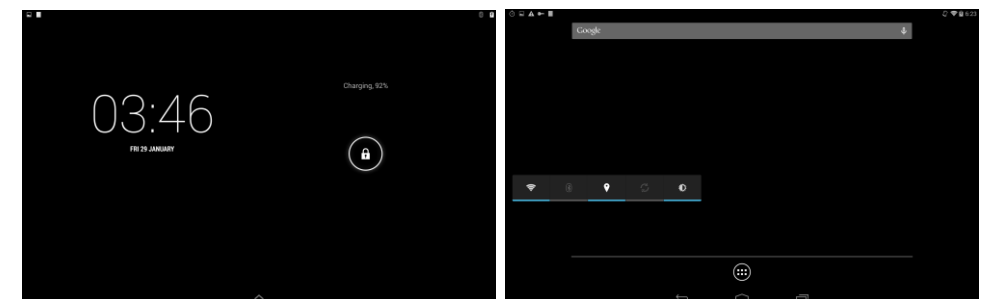

🔒: unlock key; 03:36: system clock; Charging, 92%: charging indicator; 🏠: back to homepage; ⏮: return key; 📱: run the task bar; 📶: vibrate; 🔋: charging icon; 🔵: Bluetooth icon; 📶: brightness; 🔊: volume+; 🔊: volume-; 🔇: mute; ⋮: function list; 📶: Wifi connection; 📍: locating information; 🔄: refresh; ⌚: alarm clock; 🔍: Google search; ☰: menu;

● List of application program

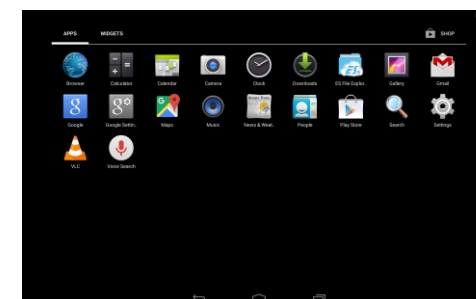

# Wi-Fi

Know how to use the network function of the tablet to start and connect to wireless local area network (WLAN) (Wi-Fi) complying with IEEE 802.11 b/g/n standard. It can be connected to Internet and other internet devices that can be connected to access point or wireless hot spot.

• **Open WIFI setting:** Click the function module menu icon "⚙️", enter the menu list, click "⚙️" to enter the settings page, click "Wi-Fi" to set entering, and then to the right to drag the "Wi-Fi" slider to open WIFI, enter the network settings. As shown in Figure:

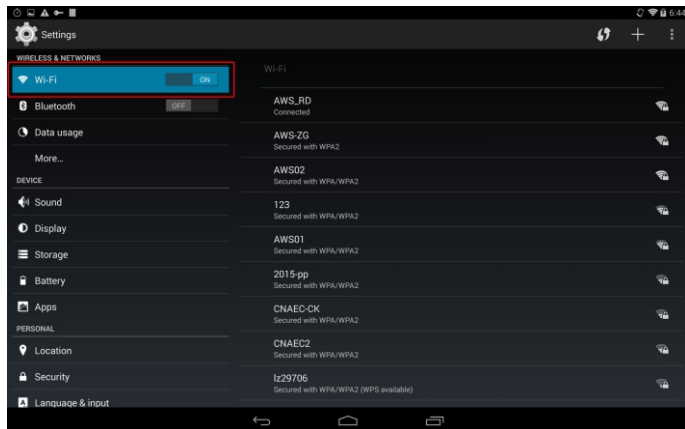

• When you click the encrypted network, enter network password, can check the password, enter the password to click the finish, click the connection. As shown in figure:

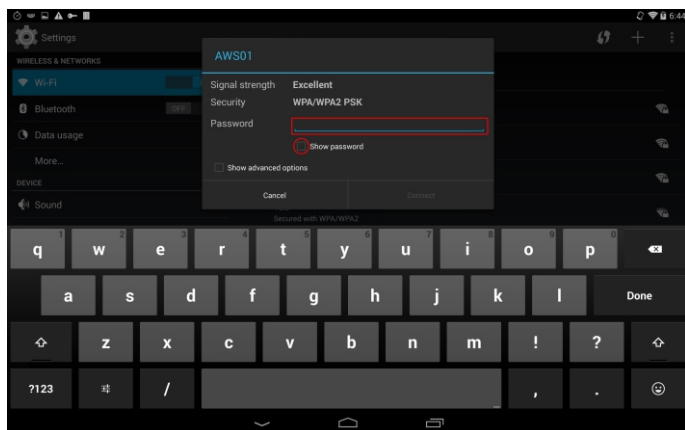

# Bluetooth

Please do not use Bluetooth for illegal purposes (such as pirated copy files or illegal eavesdropping for commercial purposes). The company will not undertake any liability for consequences due to illegal utilization of Bluetooth function.

• **Open Bluetooth setting:**

› Click the functional module menu icon "⚙️", enter function menu list, click "⚙️" for entering setting page, click "Bluetooth" setting, and then to the right to drag "Bluetooth" slider to open it. As shown in Figure:

# Bluetooth

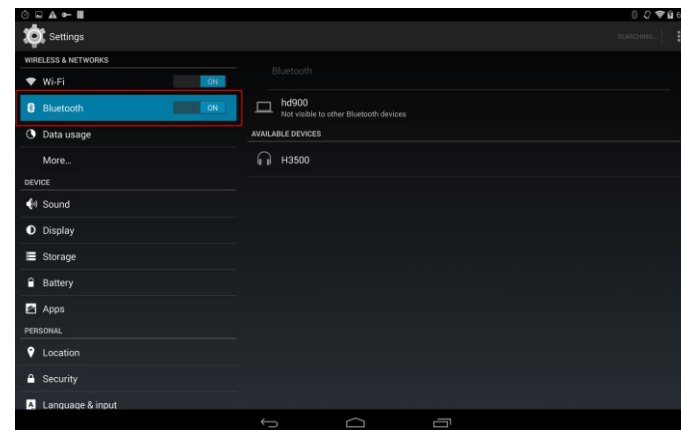

• **Look for Bluetooth device, match and communication:**

› Click the icon "⚙️", enter function menu list and select setting →Bluetooth→ **SEARCH FOR DEVICES**  
› Select the device, according to the prompt matching success, as shown in figure:

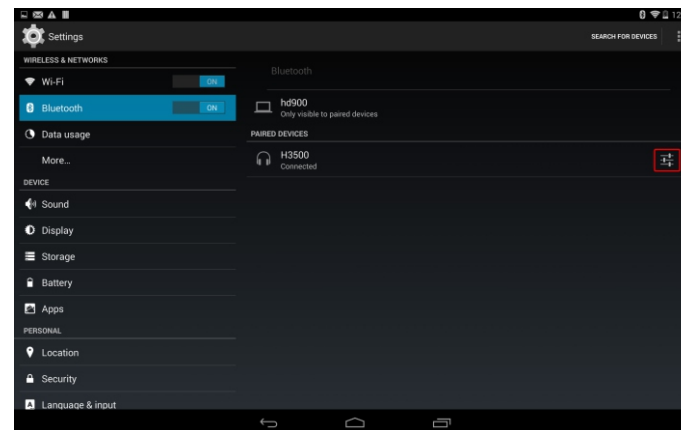

› We can rename the matched device and exit from communication by clicking "⚙️".

• **Send data via Bluetooth:**

› Select documents or items from the suitable application program.  
› Select one option to send data via Bluetooth.  
› Search the device starting Bluetooth and match with it.

• **Receive data via Bluetooth.**

› Open application program list and select setting →Bluetooth, and then select the device name.  
› After receiving the prompt, it means successful matching.  
› Choose acceptance to confirm the communication between the two devices. Received data is saved in the SD card/Bluetooth folder.

## HDMI input

External HDMI signal source (**attention:** support max 1920\*1080P 30Hz)

The external device sets up HDMI output state, connect to the "IN" interface of the tablet via HDMI cable (C-type interface), the tablet will automatically switch to HDMI play. It will automatically exit after removing HDMI cable.

(**Attention:** the tablet supports 1080P high-definition output, In order to ensure the display effect, please choose to support the better quality cable with HDMI 1.4). Connection as shown in figure:



## AV input

External AV signal source (support automatic identification of PAL and NTSC). Click function module menu icon "⚙", enter the function menu list, select the icon "AV" to enter the AV IN interface. Through the "AV IN" interface, the tablet automatically switches to the AV state, and automatically and will automatically exit after removing the external AV cable. (when the AV cable is not removed, function keys displayed by sliding down the screen from the top, press the return key to exit. )

Connection as shown in figure:



**Attention:** when HDMI and AV are input at the same time, the priority switch to HDMI. If it need be switched to AV, the HDMI cable must be removed.

## HDMI output

The external display device is set to the HDMI state, via the HDMI cable (D type interface) connected to the tablet "OUT" interface to output. (Note: as it supports 1080P high-definition output, please select high-quality HDMI cable supporting HDMI 1.4 to guarantee display effect. Different external display equipment can not display fully appearing on the left and right sides of the screen, due to different display ratio.)

Connection as shown in figure:



## USB interface

### ◆ Open USB debug switch

Click function module menu icon "⚙", enter the function menu list, click "⚙" icon to enter the setting page, click "developer option" setting to enter (open developer option reference setting), tick the block behind the "USB debugging", as shown in Figure:

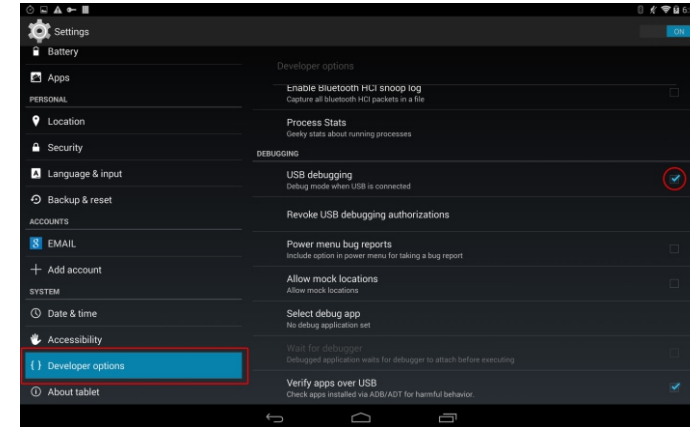

External devices connect the tablet via the USB MICRO data cable ,then there is the prompt as following dialog box, click "OK" to confirm.

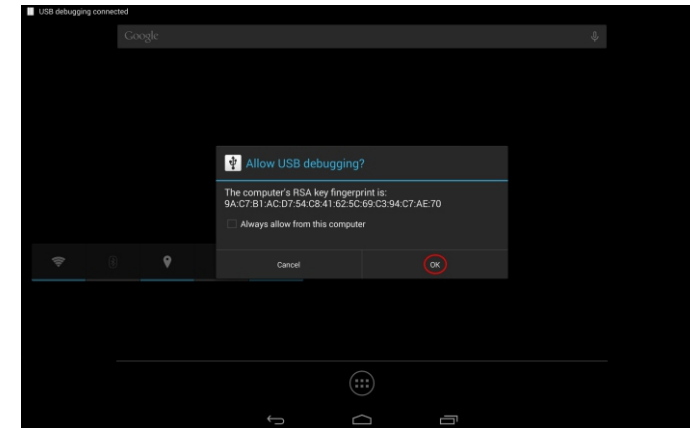

USB interface can support USB mouse and USB keyboard.

### ◆ Support DJI INSPIRE 1, PHANTOM 3/4 & MATRICE equipment.

- Download and install "DJI-GO" APK: download this APK via DJI official website and copy it into the flash or TF card of the tablet, and then install and use.
- Double click the icon "DJI-GO apk", then twice "Next" on the bottom right corner, then "Install" on the bottom right corner, then "installing" is on, after "App installed" showed on the screen, click "Done" on the bottom left corner ,now the whole installation is complete, there is icon "DJI-GO", as shown in figures :

# USB interface

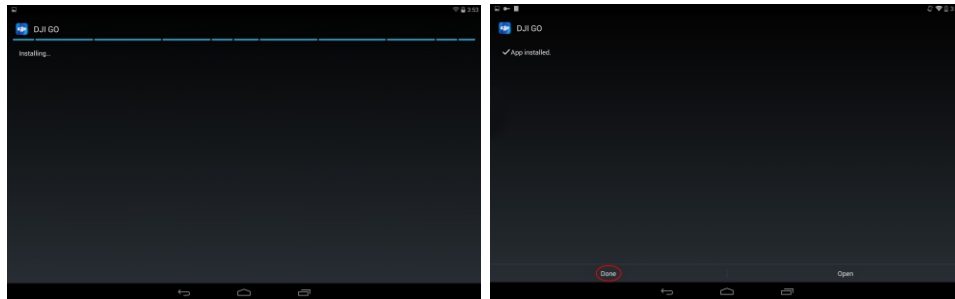
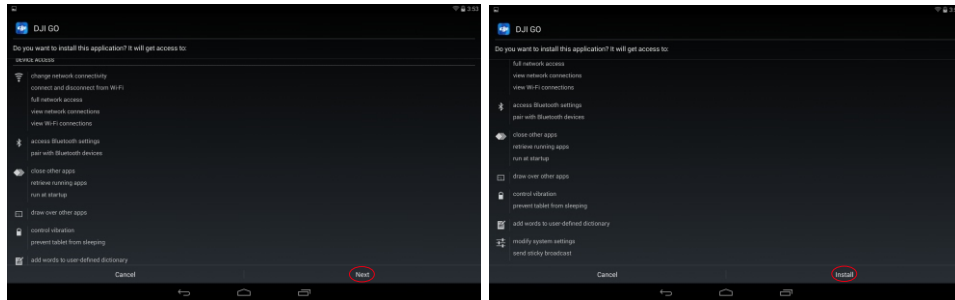
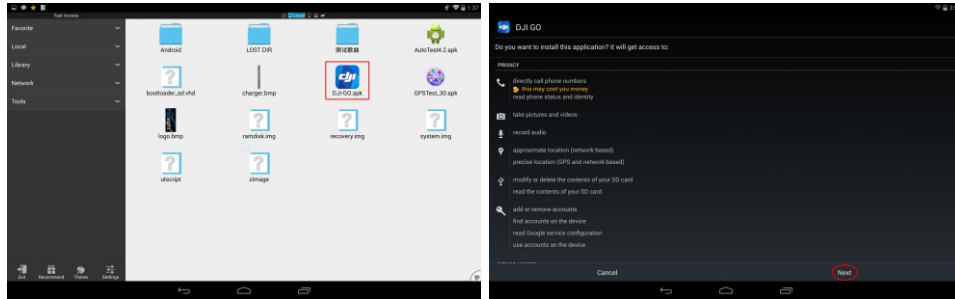

- Start DJI PHANTOM 3/4 and its RC transmitter, connection as shown in figure:



# USB interface

- Connect the tablet and RC transmitter via USB cable, pop up dialog box as shown in figure:

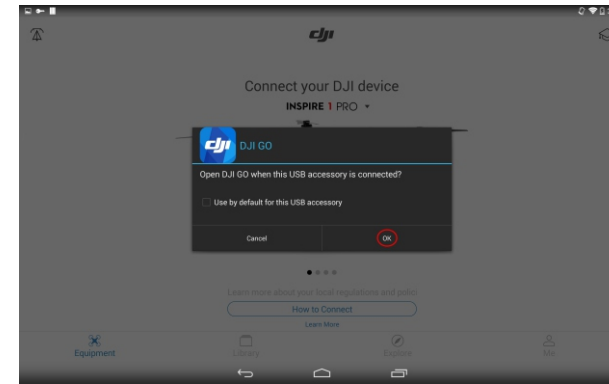

- Click "OK" for confirmation according to the prompt, as shown in the figure as below (**Attention:** as USB transmits high-speed data signal, please use good quality USB cable to guarantee stability of transmitted data. If the USB cable can not be connected or display mosaic phenomenon happens, please replace it with better USB cable.)

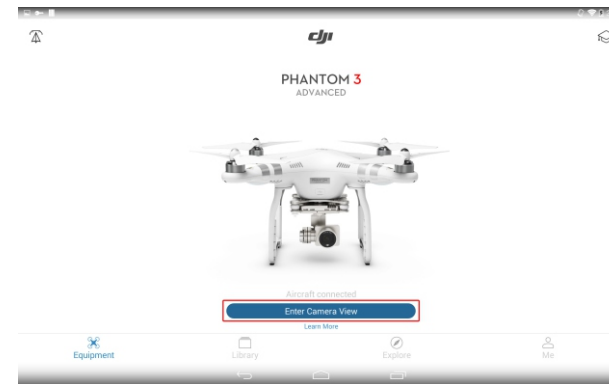

- Click "Enter Camera View", there is following figure shown:



## USB interface

Click "skip" on the above figure to enter the next figure as below:

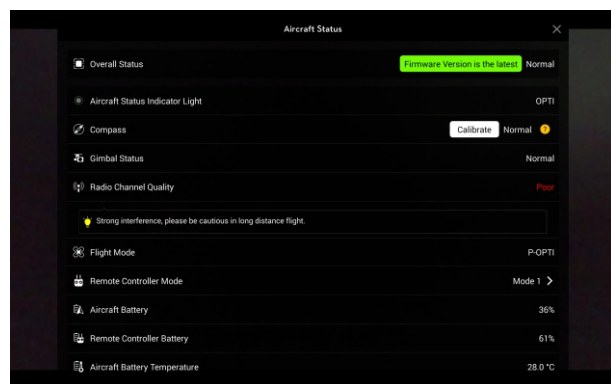

• Click "X" on the above figure to finish the whole connection. Now you can make some specific function operation of the aircraft like Phantom 3/4, Inspire and so on via "DJI-GO apk" : such as one-key return and one-key take-off. Please refer to operation manual of air-crafts like DJI Phantom 3/4. Application interface as shown in the following figure:

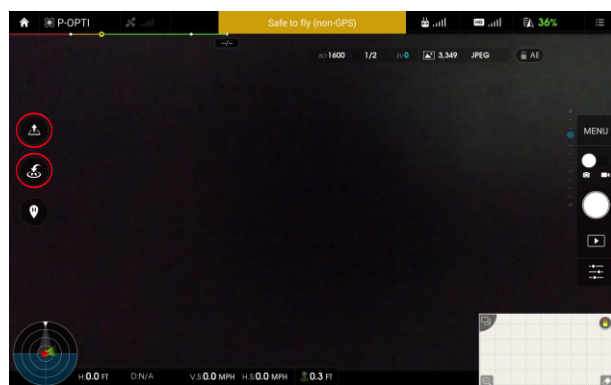

**Note:** If working with Phantom 3 Professional, please operate the taking photos mode as followings: On the application interface, click MENU→Image Ratio→16:9, as shown in the following figure:

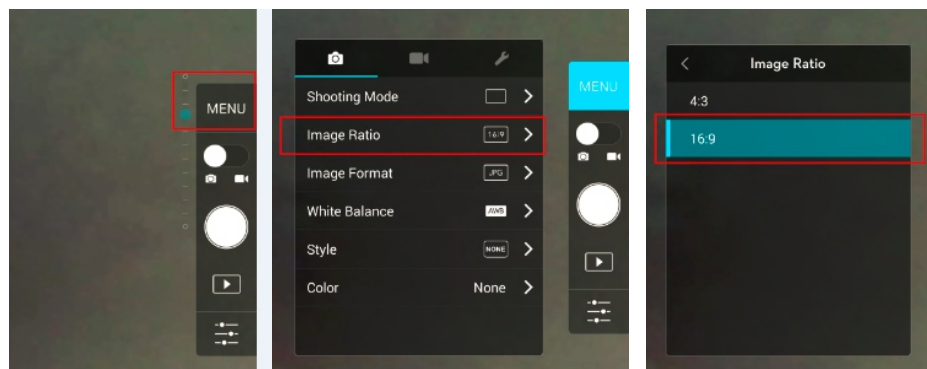

## Use TF memory card

The tablet is equipped with slot for TF memory card to read multimedia files in the TF card. When using, the TF card need be correctly inserted into the tablet according to the mark slot marking: push the card inward until the voice of clatter is heard. When taking out the memory card: please push the memory card into the slot and then release, the memory card will automatically pop up, then take it out.

- Please correctly insert the card into the slot.
- When operating the memory card (such as reading and copying), don't pull out the memory card, otherwise there may be a data error.
- Memory card shall not be used under high-temperature and high-humidity environment.
- Keep the memory card away from liquid and corrosive materials.
- The tablet can use memory card with the maximum capacity of 64GB (depending on memory card manufacturer and type). Some memory cards are incompatible with your equipment, please use the genuine memory card.

## APK installation and uninstall

APK installation: the tablet supports the third party application program based on Android platform. Most of application programs can be obtained from the network, copy them into Flash or TF card ,then install them for use.

• Click the function module menu icon "⚙" and enter function menu list, click the source manager icon "📁" to enter the management interface, click APK application installation package to run until its installation is completed, there will be corresponding software menu, an example of Auto Test4.2.apk apk as shown in the following figures:

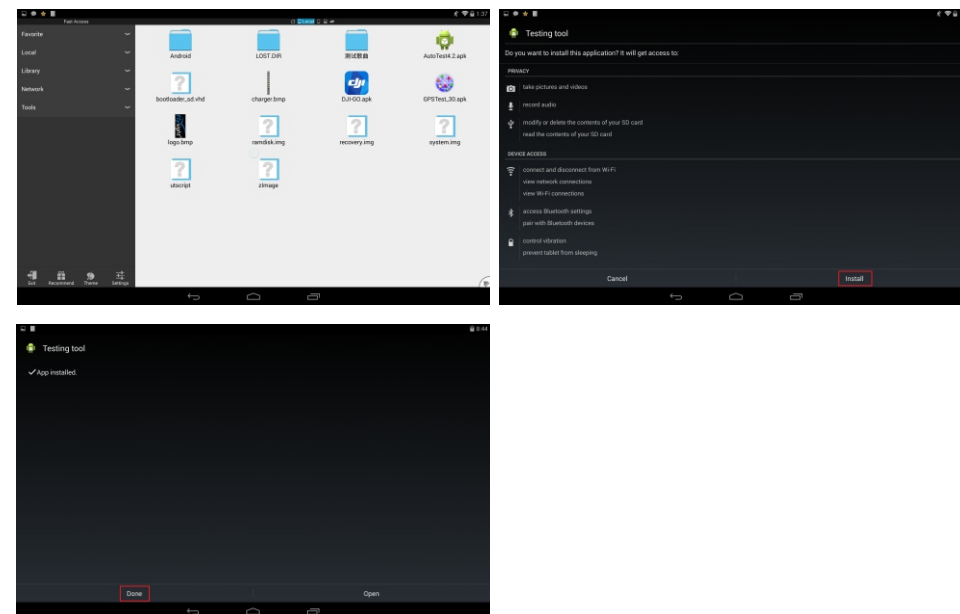

• APK uninstall: click the function module menu icon "⚙" and enter into function menu list, click the icon "📁" and enter the setting page, click "Apps" setting to select system software that you want to unload, click "Uninstall" button, pop up dialog box to click "OK", which means uninstalling is successful. As shown in the following figures:

# APK installation and uninstall

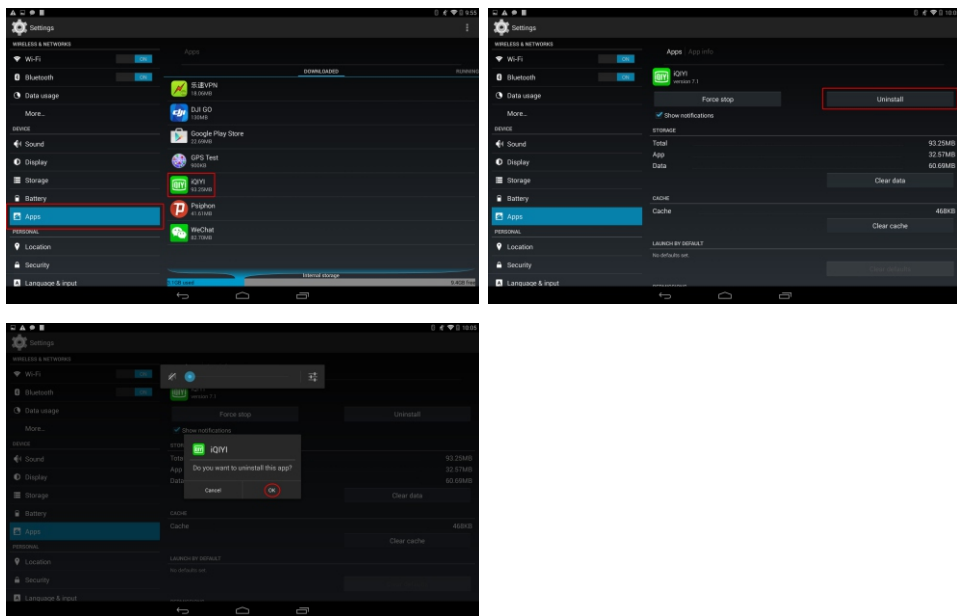

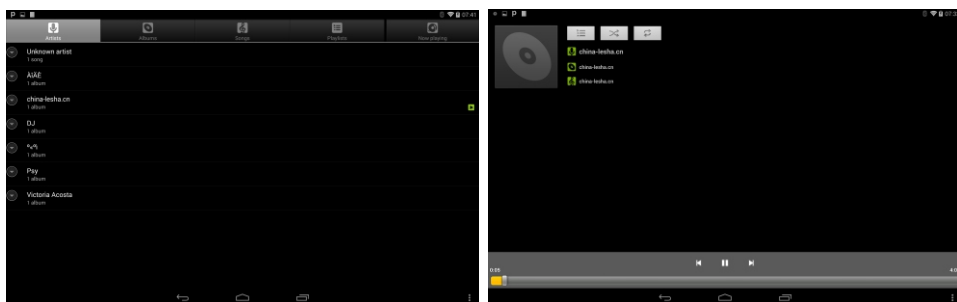

## Music

Click the function module menu icon “” and enter function menu list, click the music icon “” and enter music play, music will be played by double clicking your preferred songs, as shown in the below figures:



### •Description of music icon function

: artist; : album; : song; : play list; : random play; : loop playback; : play last song.

: play next song; : pause; : play.

### • Play music

Play progress of audio can be adjusted by dragging play progress bar .

• When the audio list of the tablet does not have music file, the system will automatically upload music files of TF card to the play list after opening the audio of the tablet (the formats of audio files supported by the tablet include: mp3, wav, midi and wma).

## Music

• Music play list area, if there is a large number of songs, the page can be turned by moving the touch screen upwards or downwards.

• Double click your preferred songs and enter the audio interface of the tablet, start to play audio files.

• Under the audio play interface, you can conduct operations of playing last song or next song, pause or play via the function key.

## Video

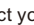
• Click the function module menu icon “” and enter function menu list, click the icon “”. Select your preferred video files according to your file storage situation and open it to play.

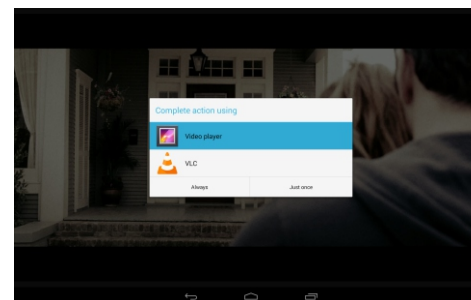
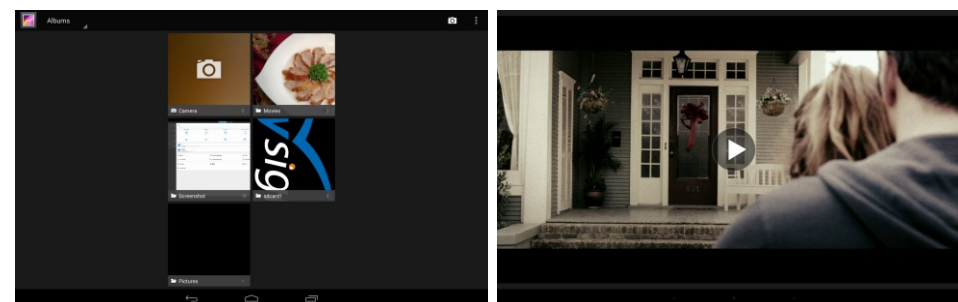



• Formats of video files supported by the tablet include: AVI, MOV, MPEG1/2/4, H.264, FLV and WMV.

• Play progress of video can be adjusted by dragging play progress bar .

• Click “” to pause play operation.

## Camera

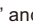
Know how to photograph and review photos and video.

Click the function module menu icon “” and enter function menu list, click the icon “” and enter the photographing interface, as shown in the below figure (default in the rear camera status):

# Camera

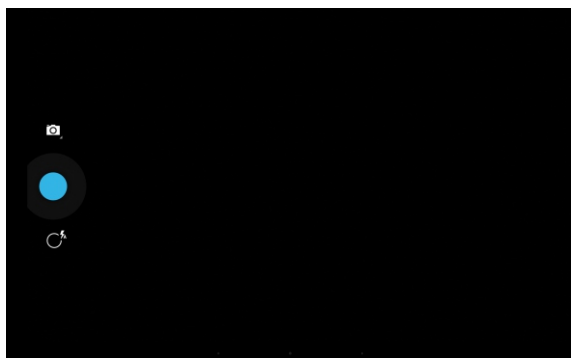

## ◆ Take photos

- Only take common simple photos, you can do as followings:

1. Align the camera lens to the object and make the necessary adjustment.
2. Use the camera photographing key or shortcut: it can photograph by pressing “volume +”, “volume -” and “” under the photographing mode.

### • Take complex photos

If you want to take photos with more auxiliary functions, please click icon “”, as shown in the below figure:

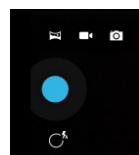

: video recording : take photos : view mode : auxiliary function

Click auxiliary function icon as shown in the following figures:

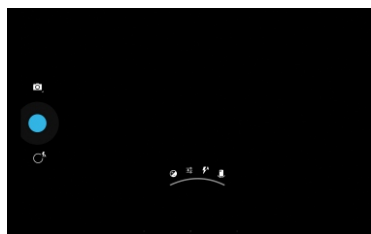

: exposure : setting : flashlight : switch

1. adjust exposure value.
2. More options (locating, count down, photo dimension, white balance, view mode).
3. Change flashlight setting: flashlight can be manually turned on or turned down or set the camera to use flashlight when needed.

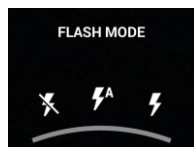
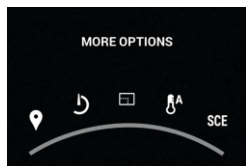

# Camera

4. Switch between the front camera and the rear camera, click the icon , as shown in the following figure:

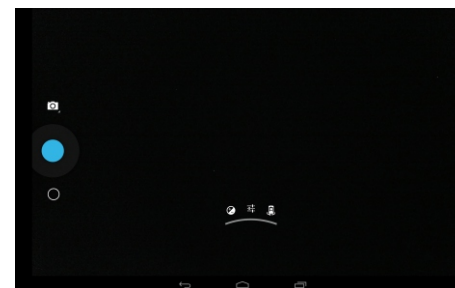

: auxiliary function : exposure : setting : flashlight : switch

- These icon functions are the same with the above ones for taking photos in the rear camera status.
- Focusing adjustment: as shown in the below figure.

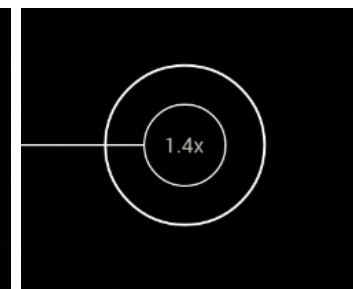
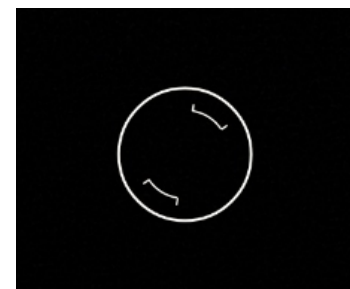

Focusing box can be pressed by using two fingers, and then corresponding adjustment will be made for the focal distance by separating fingers or folding two fingers.

› Self-define camera setting.

Before taking photos, select “[SEARCH FOR DEVICES](#)” to access the following options:

## ◆ Video recording

- Click the icon “”, as shown as following figure:
- Click the icon , enter simple recording mode.
- If you want to record more complex video, please click the auxiliary function icon “”, as default rear camera status, as shown in the following figure:

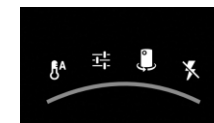
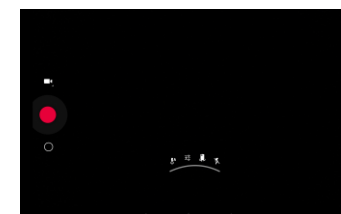
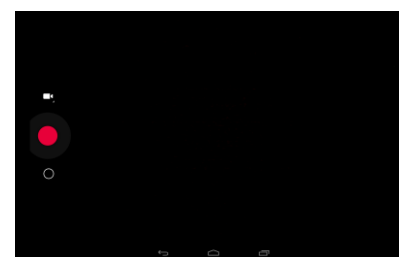

# Camera

☰: white balance    ⚙️: setting    📷: switch    🔦: flashlight

1. Click the icon ☰, as shown as following figure.

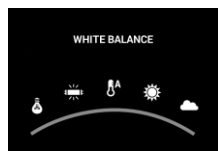

2. Click the icon ⚙️, as shown as following figure.

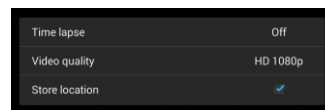

3. Click the icon 📷, you can turn on or off the flashlight.

4. Click the icon 📷, you can switch between the front and the rear camera to enter the video recording in the front camera status, click the icon 📷, as shown as the following figure:

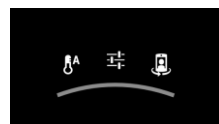
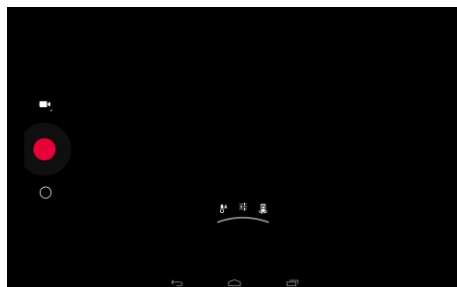

☰: white balance    ⚙️: setting    📷: switch

These icon functions are the same with the above ones for the video recording in the rear camera status.

## Record video

1. Align the lens to the object and conduct necessary adjustment.
2. Select "📷" to start recording.
3. Select "📷" to finish recording.

The video will be automatically stored.

# Gallery

• Click the function module menu icon "☰" and enter function menu list, click the icon "📷" for entering picture browsing interface:

Click the icon "📷" for selecting in aspects of photo album, place, date, figure and label by viewing folder.

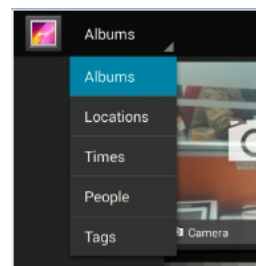
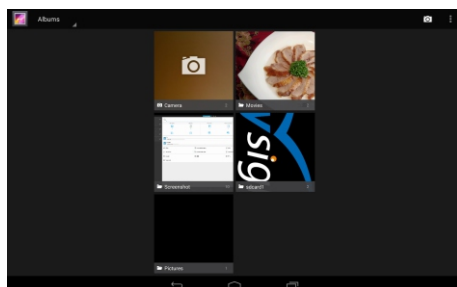

# Gallery

Select photo album → folder → image.

View pictures, open "☰", it can enter setting following option functions after entering sub menu:

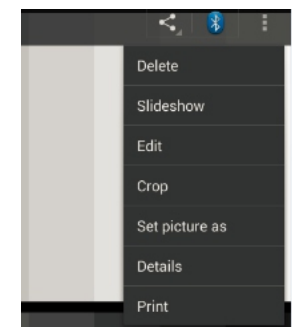

- Roll towards the right or the left for viewing more photos.

Place two fingers on the screen and slowly separate or fold for zoom in or out that can also be achieved by double clicking the screen. Please double click the screen for back to the original dimension.

1. If you want to delete photos, select → delete.
2. If you want to start the slide show, select → start the slide show. Click on the screen to stop the slide show.
3. If you want to edit photos via image editor, select → edit.
4. If you want to for cut off one part from the image, select → cut.
5. If you want to set the photo as wallpaper or image of contact person, select → setting the photo for.
6. If you want to review details of photo, select → detailed information.
7. If you want to print photos via WLAN link, select print.

# Resource manager

Click the function module menu icon "☰" and enter function menu list, click the resource manager icon "📷" to enter the management interface. As shown in the below figure:

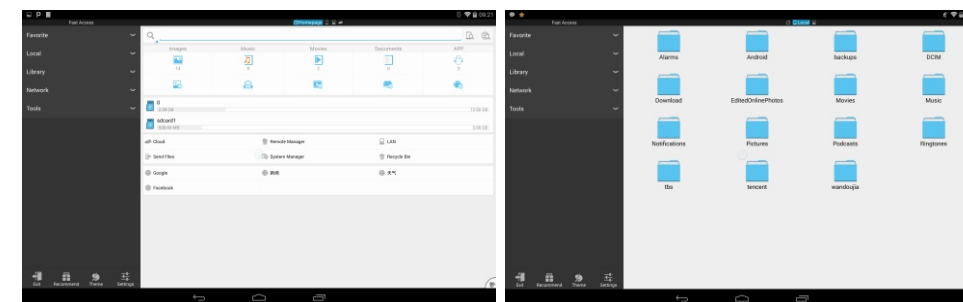

Pull-down folders and relevant files can be unfolded by clicking [SD Card1], [local] and [network hard disk]. Adding, copying, pasting and deletion can be also conducted. Select "last", "next" or "last layer" to find corresponding path by pressing single folder or file for long time, click "edit" and select to paste to corresponding path on the displayed box.

# IE Internet Explorer

Click the function module menu icon “

[Note] The explorer has used present popular third party IE software. Please operate in accordance with IE explorer standard operation .

# Email

Know how to send or check out emails via personal or corporate email address.

Click the function module menu icon “

If Google email address is not available, please click “New” and add Google account.

If Google email address is available, please directly click “Existing”, input user name and password and then click next step →next step →login.

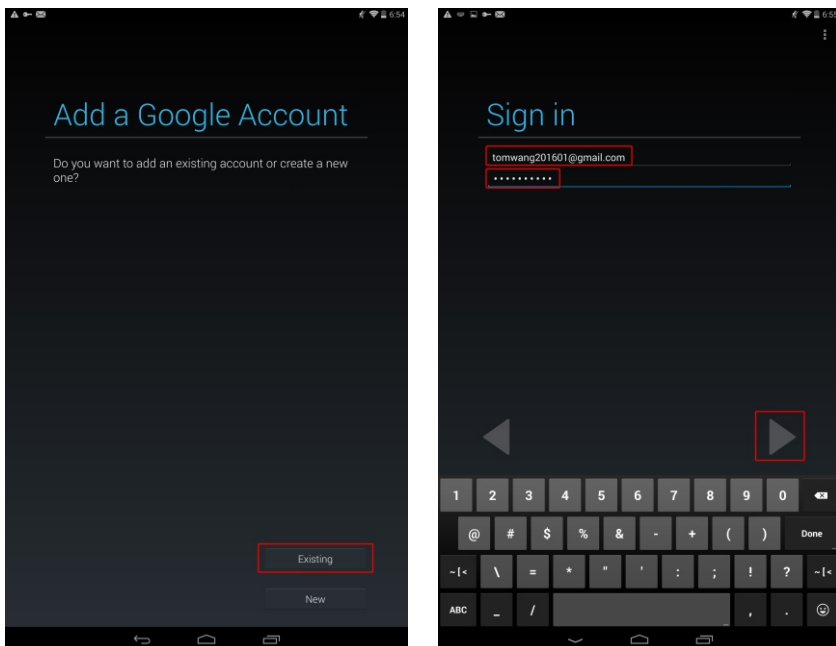

# Email

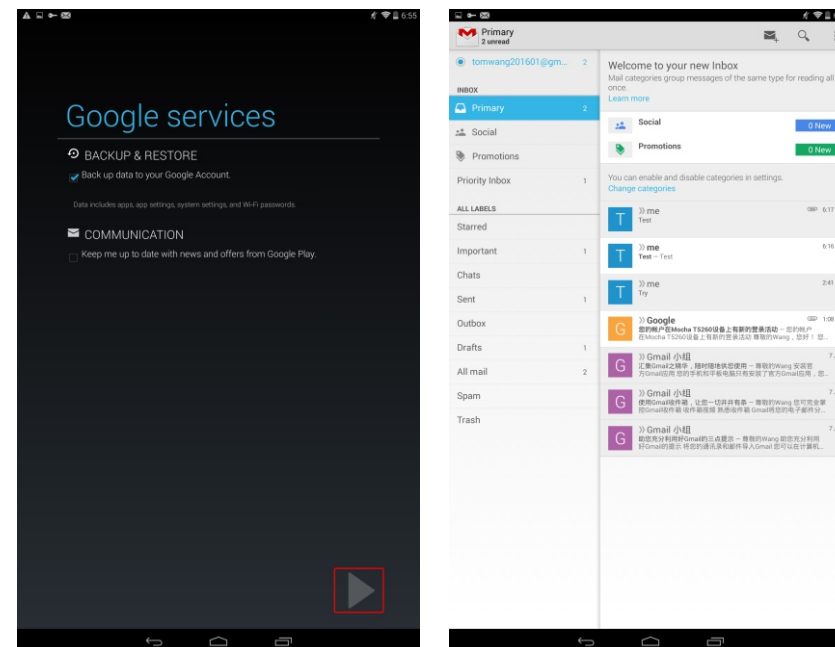





# Inbox

Automatically enter main interface of in-box after successful login:

This interface will list emails in the in-box, it can review email, reply to the sender and reply to all senders and receivers via double-click.

**Description about email button**

 : more;  : write a new mail;  : send;  : search;  : add appendix

## ◆ Write a mail

Open application program list and select email → “

Add receiver of the mail.

1. Manually input email address, multiple addresses are separated with semicolon or comma under the English mode.

2. Select email address from the list.

› Select topic field and input topic

› Select text input field and input text of email.

› Select files that need be added “

› Select “

If users are offline or are not in the service area, the email will be always kept in the outbox before it is online or it is in the service area.

# Inbox

## ◆ Check out email

After opening the email account, previous emails can be searched offline or new email can be checked out by connecting to email server. After extracting email information, it can be checked out offline.

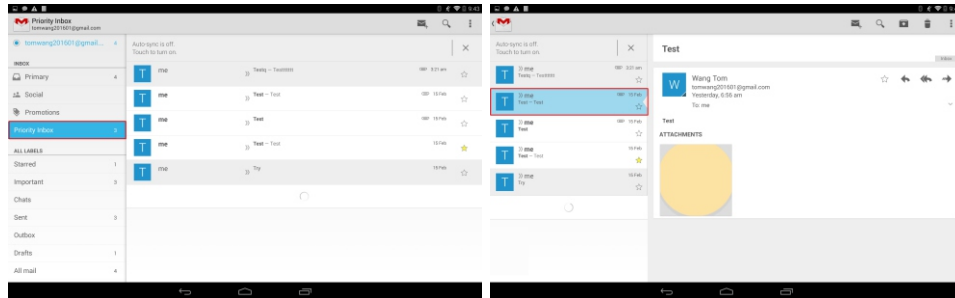

Open application program list and select email.

Select Refresh to update mail list.

Select email.

The below options can be used in the mail view:

- Select for searching for email information.
- Select Refresh for refreshing emails.
- Select for creating new mail.
- Select for replying email.
- Select for replying all emails.
- Select for forwarding emails to other contact persons.
- Select for deleting emails.
- Select for marking email with star mark.
- Select for archiving email conversation.
- Select for moving emails to other folders.

# Map

Click the function module menu icon and enter into function menu list, click the icon , it will be reminded of selecting "Agree" for entering Google Map to view the map and start locating service.

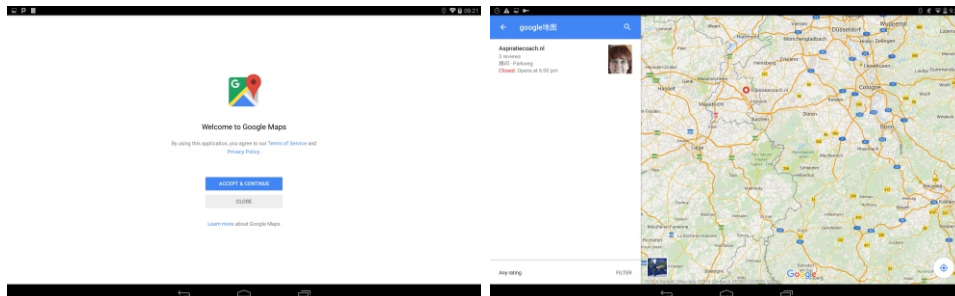

View the map: the image can be amplified or reduced by clicking the zoom in or out icon at the bottom left corner. The image can be moved towards up and down and the right or the left by dragging the touch screen. Map relevant information can be searched via place name.

# Voice search

Click the function module menu icon and enter function menu list, click the icon for entering.

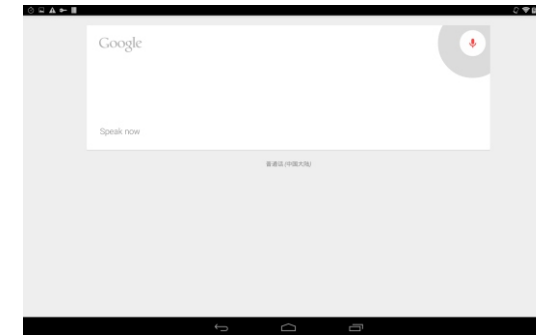

# Calendar

Click the function module menu icon and enter function menu list, click the icon for entering the calendar interface:



**Attention:** the calendar interface can be accessed after logging in via Gmail account when the tablet is used for the first time or used through factory resetting. If there is not account, new Google account need be applied.

- Change review mode

Select review mode tab for changing review mode of calendar. Review mode can also be changed by clicking the screen with two fingers and then folding or separating two fingers.

Enter the calendar interface, click the icon , review calendar activity in different ways such as day, week, month and schedule.

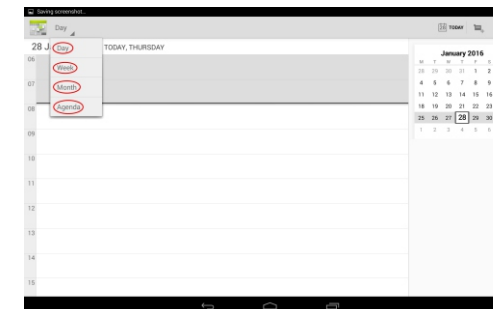

# Calendar

Can refresh and set some relevant information by clicking “ ”.



# Calculator

Click the function module menu icon “ ” and enter function menu list, click the icon “ ” of the calculator to open the calculator:

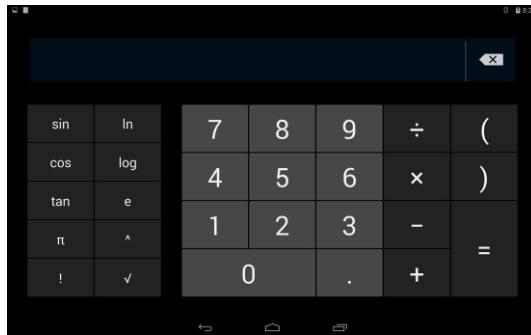

# Alarm clock/countdown counter/stopwatch

Click the function module menu icon “ ” and enter function menu list, click the icon “ ” for entering into clock interface:

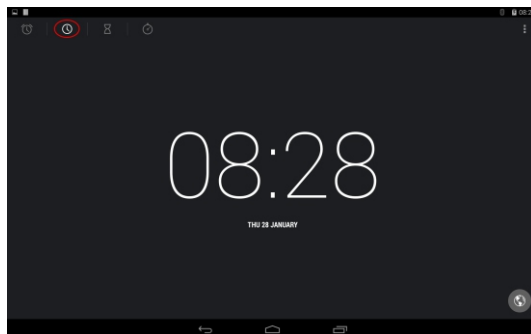

# Alarm clock/countdown counter/stopwatch

- Click the icon “ ” for setting alarm clock.

The tablet supports to set multiple alarm clocks at the same time. Tick boxes behind clock number of alarm clock, as shown in the below figure:

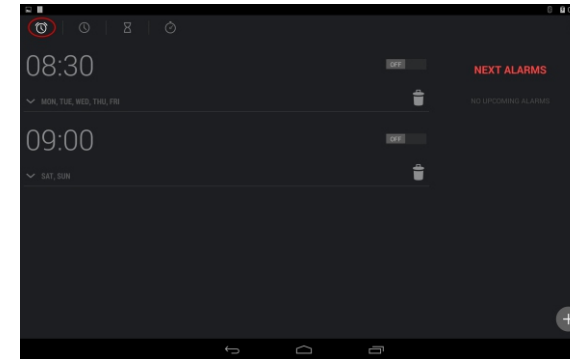

It can set details of alarm clock by clicking any clock number of above alarm clocks: time of alarm clock, ring of alarm clock, vibrate or not, repeated situation of alarm bell, label setting.

Every day: set the alarm clock to ring the bell repeatedly at the same o'clock of every day;

Monday, Tuesday, Wednesday, Thursday, Friday, Saturday, Sunday: check number of days that you require, for example: you require alarm clock from Monday to Friday, please respectively check boxes behind Monday to Friday and set the alarm clock to ring the bell repeatedly at the same o'clock from Monday to Friday; none: the alarm clock will be rung for once.

- Click the icon “ ” for setting countdown counter.

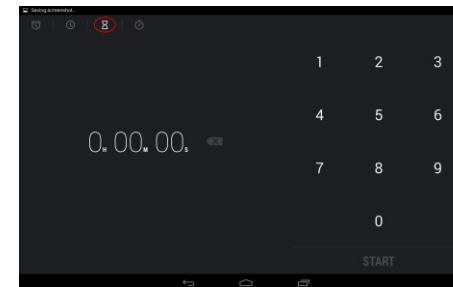

- Click the icon “ ” for setting stopwatch.

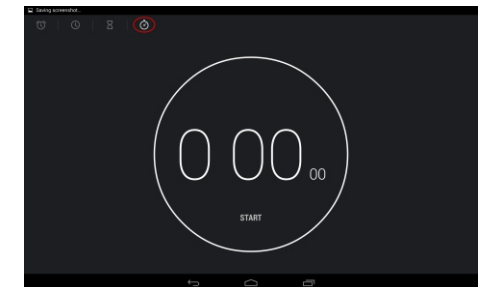

# Setting

Open application program list and select setting.,  
Select setting type and then select option.

## Basic setting

### WIFI setting

Start WIFI function to connect to WIFI network and access to Internet or other network equipment.

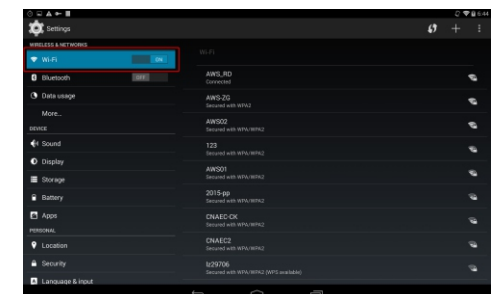



# Setting

- › Encryption: set password to encrypt data stored in the tablet. Password must be input when starting the tablet. As encrypted data may be used for over one hour, please charge the battery at first before starting this setting.
- › Password: it will be set so that input content will be displayed after inputting password.
- › Equipment management:
  1. Equipment manager: review manager recognized by the tablet, the tablet manager can be allowed as new strategy of the tablet application.
  2. Unknown source: set the tablet to install application program downloaded from any sources.
  3. Verification application: prohibit to install application that may generate dangers or warn before installation.
- › Voucher storage:
  1. Storage type: hardware support.
  2. Trusted voucher: set as utilization certificate and voucher to guarantee safe utilization of application program.
  3. Install from storage space of the tablet: install encryption certificate stored in USB storage tablet.
  4. Eliminate certificate: delete voucher from the tablet and reset password.

## ◆ Language and input

Change setting of language and text input.

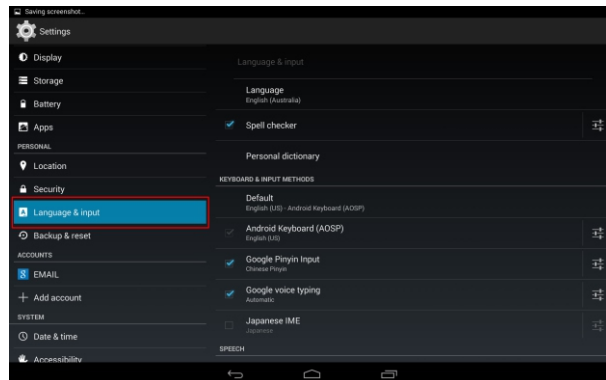

### • Language input method:

- › Language: select display language.
- › Spell check tool: setting of spell check tool.
- › Individual dictionary: setting of languages in individual dictionary.

### • Keyboard and input method

- › Default: select text input method.
- › Google input method: start Google input method.
- › Android keyboard (AOSP): setting of Android keyboard (AOSP).
- › Google voice input: setting of Google voice input.
- › Japanese IME: start Japanese IME.

### • Speech

- › Speech search: starting setting of speech search.
- › Text To Speech (TTS) output.

Select TTS engine: Google text to speech engine, Pico TTS.

Routine: speed, listening to the sample, , default language status.

### • Mouse/touch tablet

- › Pointer speed: adjust the connection to the pointer speed of the mouse or touch control board of the tablet.

# Setting

## ◆ Backup and resetting

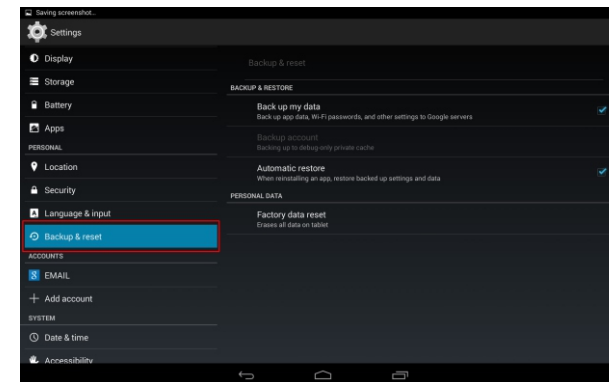

Backup and restore: can back up application data to Google server. Back up account and restore auto backup settings and data.

• Individual data: recover factory setting, reset setting as factory default value and delete all data.

• Add account: add Google MAP Company.

### • Date and time

Change setting to control how the time and date are displayed on the tablet. If the battery has not been charged all the time, time and date will be reset.

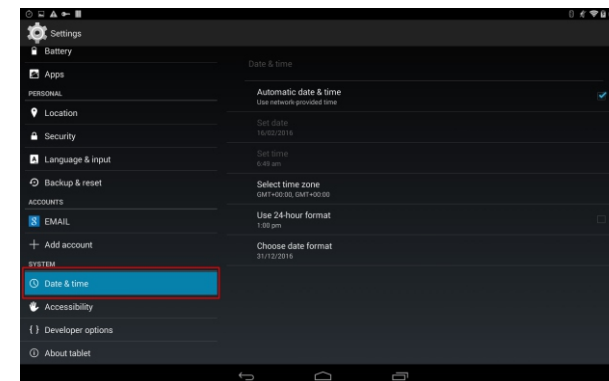

› Automatically confirm date and time: set the tablet to receive time information from network and automatically update time and date.

› Set date: manually set present date.

› Set time: manually set present time.

› Select time zone: select time zone.

› Use 24-hour system: the time will be displayed as per the format of 24 hours or the format of 12 hours via setting.

› Select date format: select date format.

## ◆ Auxiliary functions

Accessible service is special function designed for some personnel with physical disability. Accessibility of the tablet interface and function can be improved by changing setting.

# Setting

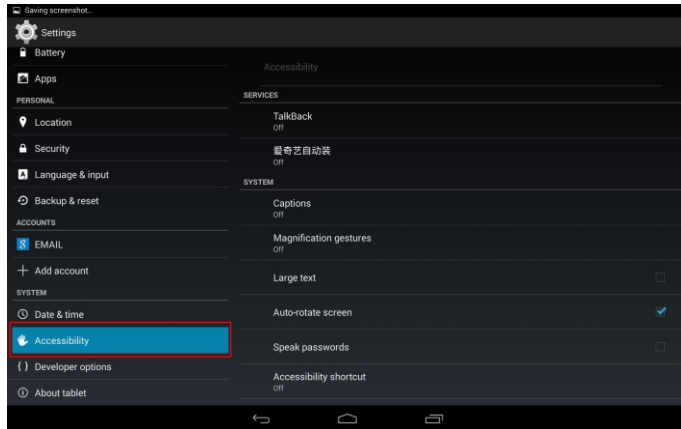

- Talk Back: start verbal reminder, the tablet will say out specific contents that you have touched, selected and activated.
  - Subtitle: subtitle setting.
  - Amplification: starting of amplification gesture.
  - Large-size font: starting of large-size font.
  - Auto-rotating screen: interface will automatically rotate when you rotate the tablet via setting.
  - Say-out password: starting say-out password.
  - Shortcut of auxiliary functions: add shortcut to auxiliary function setting. This shortcut will appear when pressing the power key.
  - Text to Speech (TTS) output.
- Select **TTS** engine: Google text to speech engine, Pico TTS.
- Routine: speed, listening to the sample, , default language status.
- Touch and press delay: setting of short delay, intermediate delay and long delay.

## ◆ About the tablet

Check the information related to the tablet such as model and version. It can be downloaded via firmware update (FOTA) service. If firmware update need be checked, please select system update →update.

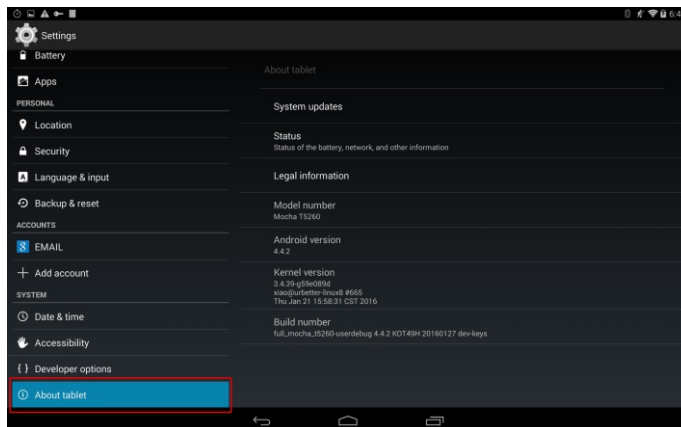

# Setting

Starting method of developer option: click application program on the standby interface → click setting →select →about the tablet →continuously click internal version number (can preview rest number of times according to pop up reminder) →developer option can be dispatched by returning to the former menu.

Change setting of application program development.

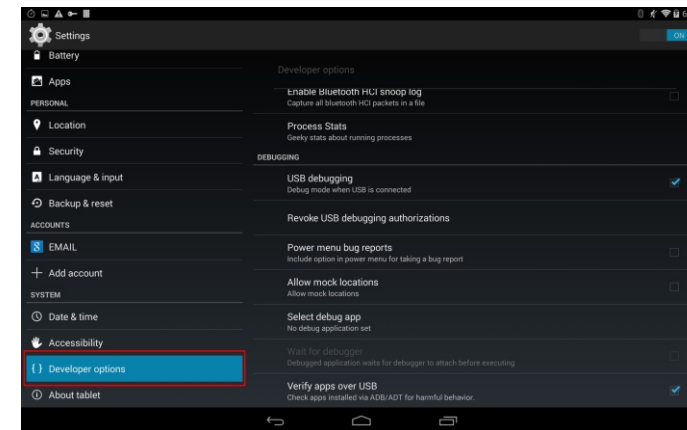

- USB debugging: start USB debugging mode to connect the tablet to the computer via USB data line.
- Allowable analog position: allow to send analog position and service message to position management service for test.
- Position of display pointer: set the coordinate and track of display pointer when touching the screen.
- Position of display touch: set the display pointer when you touch the screen.

# Software upgrade

The tablet need be turned off before upgrading. Upgrading files will be copied to root directory of TF memory card (note: TF card for upgrading must be 4G at least and has not been partitioned). TF memory card will be inserted into the tablet as per the marked method. Keys of "POWER" and "volume +" will be pressed at the same time until "Flysight" logo comes out,then release the keys, enter upgrading interface to upgrade. It will restart automatically after the upgrading,then the upgrading is complete.

**Attention: please make sure the electric volume of the battery is sufficient before upgrading. Please do not cut off electricity in the process of upgrading. Please ask for upgrading files with dealers.**

# Main specification table

	Technical specifications	
<b>Processor</b>	Exynos 5260	
<b>RAM</b>	2GB DDR3	
<b>Storage</b>	16GB EMMC	
<b>Interfaces</b>	<b>Front camera</b>	5 Mega Pixel, Back camera 8 Mega Pixel with flashlight
	<b>HDMI output</b>	HDMI 1.4 Type D
	<b>HDMI input</b>	HDMI 1.4 Type C (max resolution 1920*1080p @ 30Hz)
	<b>AV input (analogue)</b>	supports PAL and NTSC supported resolutions AV-input: 640*480, 720*576
	Micro USB 2.0	
	Headphone jack 3.5mm	
<b>Display Screen</b>	9 inch (22,86cm)	
	<b>Brightness</b>	500cd/m2
	<b>Contrast</b>	1200:1
	<b>Resolution</b>	2560*1600
	10 point anti glare touchscreen	
<b>Expandable memory</b>	Supports Transflash cards 128MB ~ 64GB	
<b>Wifi Standard</b>	802.11b/g/n	
<b>Bluetooth</b>	Bluetooth 4.0 (Enhanced Data Rate)	
<b>GPS</b>	supports GPS navigation	
<b>Speaker</b>	0.5 Watt	
<b>Power supply</b>	10W	
<b>Operation System</b>	Android 4.4.2	
<b>Dimensions</b>	237.5(H)* 154 (W)* 10.5(D)mm(not include sun shadow) 242(H)* 159 (W)* 18(D)mm( include sun shadow)	
<b>Weight</b>	580g(not include sunshade) 730( include sunshade)	
<b>Supported languages</b>	Simplified chinese, tradiotional chinese, english, japanese, french, german, spanish and other	
<b>Video format support</b>	Supports 1080p (1920*1080), file format including AVI, MOV, MPEG 1/2/4, H.264, FLV, WMV ...	
<b>Audio format support</b>	Mp3, WMA, AAC, OGG ...	

# Troubleshooting

## 1. The tablet can not be started.

- The tablet may not be started when the electric volume of the battery is extremely insufficient, please charge the battery via USB computer or power adapter and try to restart the tablet under the premise of guaranteeing sufficient electric volume.
- Press the POWER key on the top of the tablet for 20 seconds and then restart the tablet to confirm whether the tablet is normal or not.
- Check whether the charger is well connected or not.

## 2. Standby time of the tablet is too short.

- Utilization time of lithium battery will be different due to different temperature environment and utilization situation. If the environmental temperature is too high or too low, utilization time of the battery will be affected. It is recommended that the tablet is used under normal temperature!
- From the aspect of utilization situation, the power consumption of large screen of the tablet is relatively large. Meanwhile, actual utilization time is also different due to volume increase, starting of special effects of sound stage and frequent operation.

## 3. Voice can not be heard via earphone.

- Please check whether the volume is set as 0 or not.
- Check whether music files damaged or not, and confirm through playing other music. If the document is damaged, it may generates severe noise or leap sound.

## 4. Files can not be copied.

- Confirm whether the tablet is correctly connected to the tablet or not.
- Confirm whether memory space of the memorizer is full or not.
- Confirm whether USB cable is damaged or not.

## 5. Connection is not established after connecting the tablet to the computer.

- Make sure USB cable is compatible with the tablet.
- Make sure that the tablet has installed proper drivers and drivers have been updated.

## 6. Can not find another Bluetooth equipment.

- Make sure the tablet has started wireless function of Bluetooth.
- Make sure that the device you want to connect has started with Bluetooth wireless capability (if necessary).
- Make sure that the distance from the tablet to another Bluetooth equipment is within the maximum Bluetooth scope (10m).